

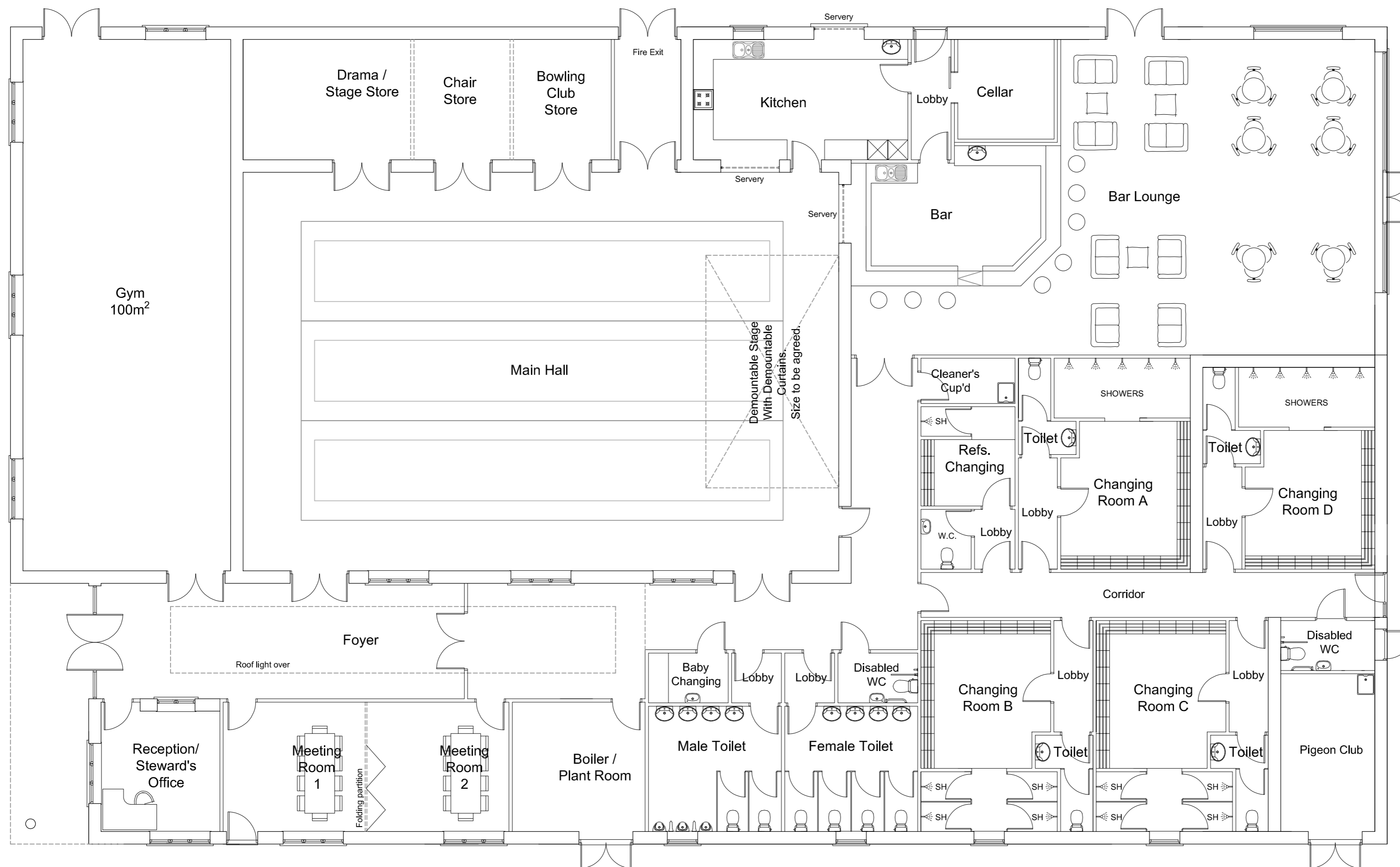

Partnership
 © Copyright:
 This drawing shall not be reproduced in whole or in part without written permission

MAY BE SCALED FOR PLANNING PURPOSES ONLY



Rev.	Date	Description	By
B	05/01/17	Demountable stage relocated. Boiler room widened to 4m with Parish Council office removed to create two meeting room (with partition wall). Bar area enlarged with double doors added to bar lounge. Changing room c and pigeon room swapped, with changing room d brought down in order to square off lounge area.	AHu
A	06/12/16	Demountable stage relocated. Additional doors added to the rear of the stage area. Additional fire exit routes added from the stage area. Additional fire exit routes added from the main hall, storage rooms amended to suit. Adoptable gym changed to parish council offices and meeting rooms, internal terrace area.	DAT

Architects
 Building Surveyors
 Project Managers
 Principal Designers
 Land Agents

Levitt Partnership Limited
 57 London Road
 Biggleswade
 Beds SG18 8EU
 Tel.: 01767 312808
 Fax: 01767 313400



Client Rowan Homes

Project
 Community Centre, Shillington.

Drawing Title
 Community Centre with Gym
 Option 1a

Job No.	12495	Scale	1:100@A2
Drawing No.	22	Date	Jan 17
Rev.	B	Drawn	AHu

CAD REF:- Z:\Drawings\

